

Engine Compartment Fuse Box

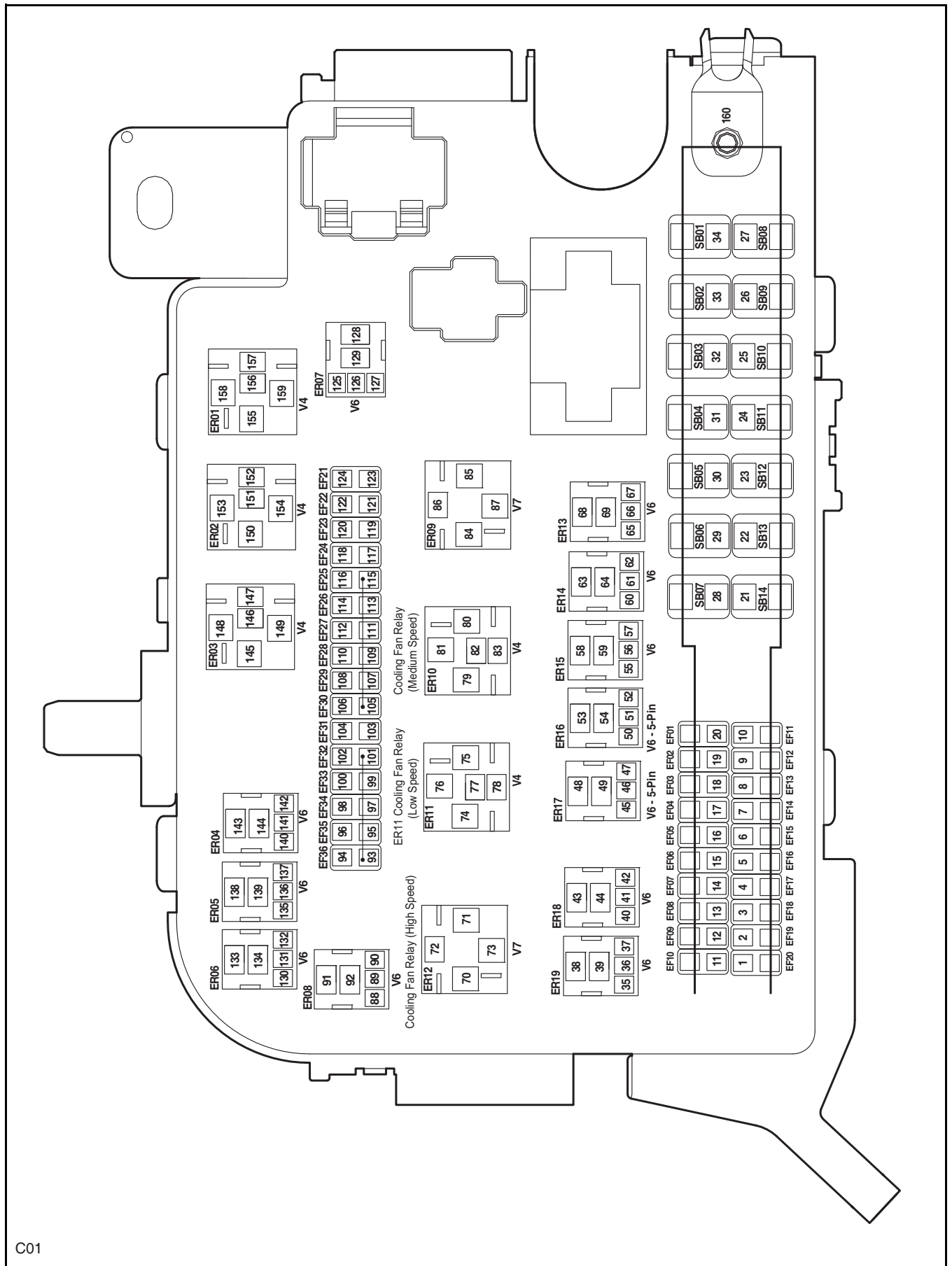

C01

## Engine Compartment Fuse Box Relay Definition

Code	Application	Description
ER01	IG1 Relay	-
ER02	Main Relay	-
ER03	Front Blower	-
ER04	Compressor	-
ER05	Low Beam Lamp Relay	-
ER06	Rear Defroster Relay	-
ER07	Starting Motor Relay 1	-
ER08	ACC Relay	-
ER09	-	-
ER10	Radiator Fan Relay (Medium Speed)	-
ER11	Radiator Fan Relay (Low Speed)	-
ER12	Radiator Fan Relay (High Speed)	-
ER13	Rear Wiper	-
ER14	Start Relay 2	-
ER15	Horn	-
ER16	Front Wiper Low Speed	-
ER17	Front Wiper High Speed	-
ER18	Oil Pump	-
ER19	-	-

## Engine Compartment Fuse Box Fuse Definition

Code	Application	Rated Current (A)	Description
EF01	Low Beam Lamp	20A	-
EF02	Front Wiper Motor	25A	-
EF03	-	-	-
EF04	TCU Constant Power Supply	15A	-
EF05	-	-	-
EF06	Main Relay	30A	-
EF07	Oil Pump Relay	20A	-
EF08	Horn Relay	20A	-
EF09	Compressor	10A	-
EF10	Rear Wiper Motor	20A	-
EF11	-	-	-
EF12	ECU	10A	-
EF13	Battery Sensor	5A	-
EF14	Brake Switch	10A	-
EF15	Shift Controller	25A	-
EF16	-	-	-
EF17	-	-	-
EF18	-	-	-
EF19	-	-	-
EF20	-	-	-
EF21	Rearview Mirror Heater	10A	-
EF22	-	-	-
EF23	-	-	-
EF24	-	-	-
EF25	-	-	-
EF26	Brake Switch	10A	-
EF27	ECU	20A	-
EF28	Ignition Coil	15A	-
EF29	Oxygen Sensor and Carbon Canister	15A	-
EF30	Relay Control Power Supply	10A	-
EF31	-	-	-
EF32	Seat Heater	10A	-
EF33	-	-	-
EF34	Electric Parking	5A	-
EF35	ECU	10A	-
EF36	Automatic Transmission	10A	-

Code	Application	Rated Current (A)	Description
SB01	Electric Parking EPBI	40A	-
SB02	IGN2, Start	30A	-
SB03	Middle Speed Fan	50A	-
SB04	Blower Relay	40A	-
SB05	IGN1, ACC	30A	-
SB06	Instrument Cluster Constant Power Supply 1 IPB1	60A	-
SB07	Power Back Door	30A	-
SB08	Electric Parking EPBI	60A	-
SB09	-	-	-
SB10	Low Speed Fan	40A	-
SB11	Window Motor (Right)	30A	-
SB12	Window Motor (Left)	30A	-
SB13	Instrument Cluster Constant Power Supply 2 IPB1	60A	-
SB14	Rear Defroster Relay	30A	-

Instrument Panel Fuse Box

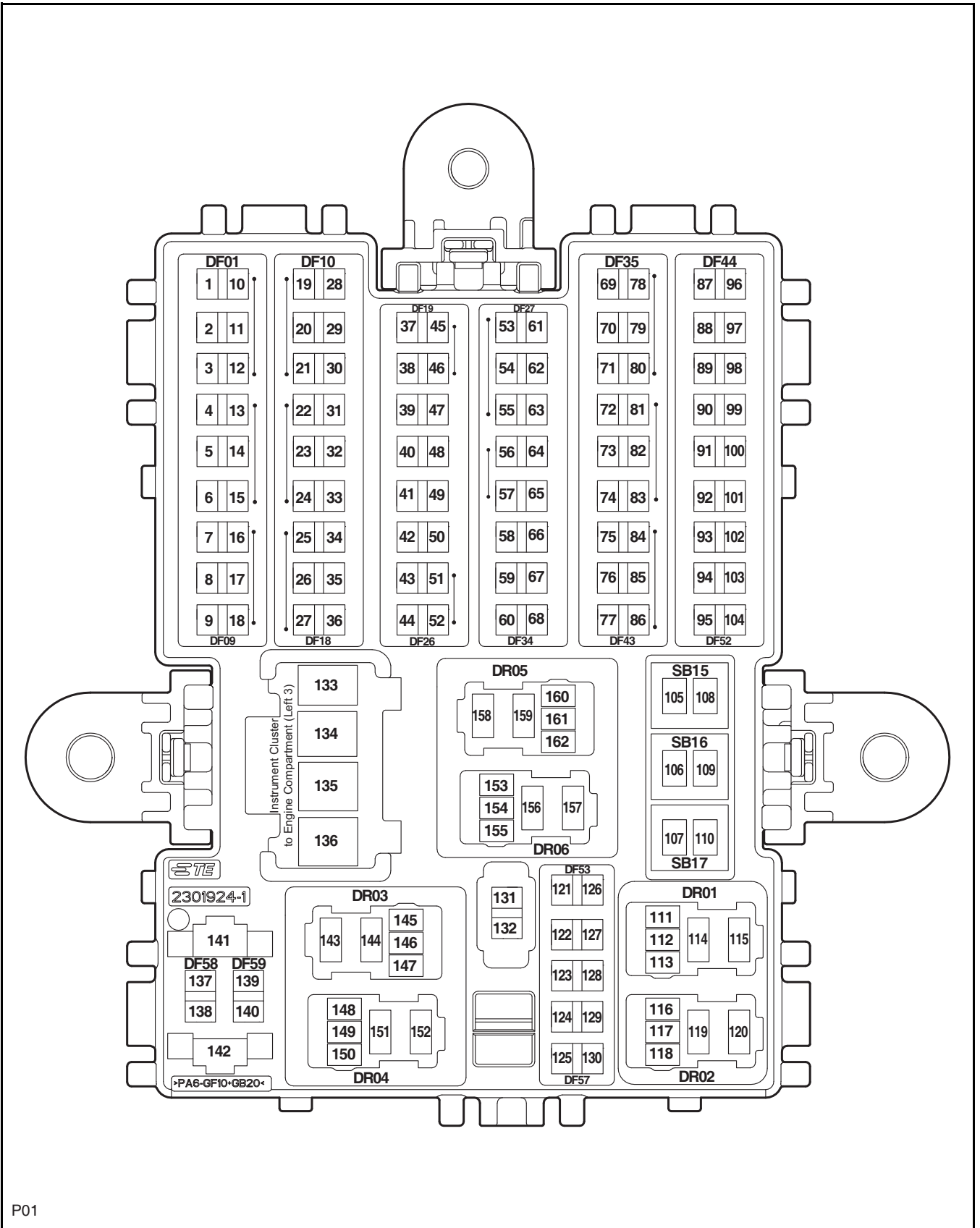

P01

---

**Instrument Panel Fuse Box Relay Definition**

<b>Code</b>	<b>Application</b>	<b>Description</b>
DR01	Front Windshield Heater (Left)	-
DR02	Front Windshield Heater (Right)	-
DR03	Other Three Door Handles Extending	-
DR04	Other Three Door Handles Retracting	-
DR05	Left Front Door Handle Retracting	-
DR06	Left Front Door Handle Extending	-

## Instrument Panel Fuse Box Fuse Definition

Code	Application	Rated Current (A)	Description
DF01	RKE, Kick Sensor, Gateway	10A	-
DF02	Data Link Connector	10A	-
DF03	BCM	20A	-
DF04	BCM	15A	-
DF05	BCM	15A	-
DF06	BCM	15A	-
DF07	BCM	15A	-
DF08	BCM	15A	-
DF09	BCM	15A	-
DF10	Sunroof Controller	20A	-
DF11	Window Delay Relay, Memory Switch	10A	-
DF12	A/C Controller, Instrument Panel Switch Box, Atmosphere Lamp, Front Display	10A	-
DF13	EPB Switch, Electronic Shift	10A	-
DF14	THU	20A	-
DF15	Rain Sensor, Steering Wheel, IP	10A	-
DF16	Power Back Door Controller	10A	-
DF17	Driver/Front Passenger Seat Heater	25A	-
DF18	Rear Blind Spot Monitoring	10A	-
DF19	TBOX	10A	-
DF20	Rear Seat Heater	20A	-
DF21	-	-	-
DF22	-	-	-
DF23	-	-	-
DF24	4WD Controller	15A	-
DF25	Left Front Door Concealed Handle	10A	-
DF26	Other Three Door Concealed Handles	15A	-
DF27	Front USB, Wireless Charging	10A	-
DF28	Front Power Outlet	15A	-
DF29	Second-row USB	10A	-
DF30	TBOX	10A	-

Code	Application	Rated Current (A)	Description
DF31	THU, Rearview Mirror Anti-glare	10A	-
DF32	-	-	-
DF33	-	-	-
DF34	-	-	-
DF35	GW, Rotation Angle Sensor	10A	-
DF36	Front Wiper Switch, Motor	15A	-
DF37	Airbag Control Unit	7.5A	-
DF38	Panoramic/APA, Power Amplifier	10A	-
DF39	Instrument Cluster, Ion Generator, A/C, Front Display	10A	-
DF40	LDW, Roof Dome Lamp	10A	-
DF41	Shift Control Mechanism, Central Box Switch, 4WD Switch	10A	-
DF42	LCDAL/LCDAR	10A	-
DF43	-	-	-
DF44	-	-	-
DF45	4WD Controller	5A	-
DF46	-	-	-
DF47	-	-	-
DF48	-	-	-
DF49	-	-	-
DF50	-	-	-
DF51	Front Windshield Heater (Left)	30A	-
DF52	Front Windshield Heater (Right)	30A	-
SB15	Power Seat Adjustment (Driver)	30A	
SB16	Seat Memory	30A	
SB17	Power Seat Adjustment (Front Passenger)	30A	